



GAMMA PRODOTTI DN 65+

STANDARD O PERSONALIZZABILI



www.cipriani-phe.com

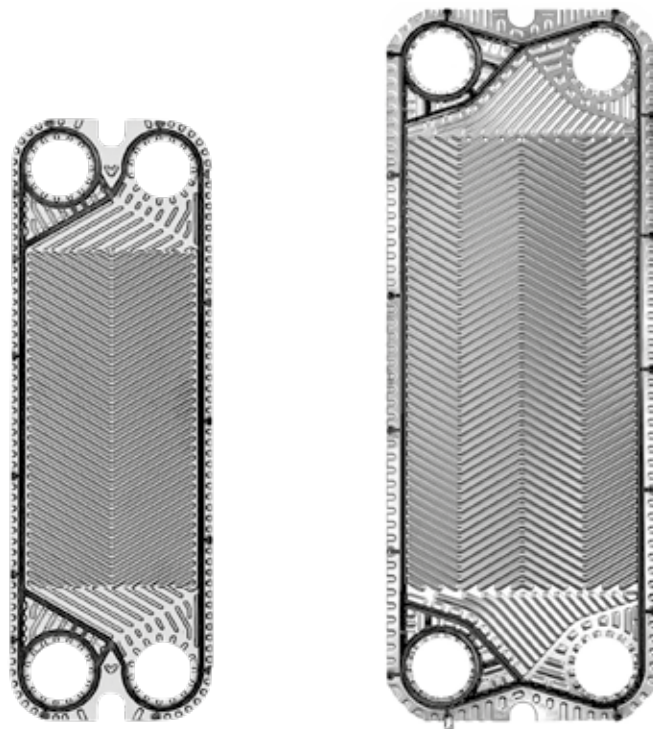

Gamma Prodotti	P125+		P180+
Area di scambio [m ²]	0,125		0,18
Larghezza [mm]	245		320
Altezza [mm]	723		844
Diametro connessioni	DN65 2"1/2		DN65 2"1/2
Capacità canale [l]	0,366		0,5
Quota di serraggio [mm]	3,3		2,85
Peso piastra (con guarnizione) [Kg]	0,69		1,03
Angolo di corrugazione	A/B		A/B
Portata max d'acqua [m ³ /h]	80		83
PS=> Pressione max di esercizio [bar]	10	16	10

Ex art. 3.3 D.Lgs. 93 del 25/02/2000 in applicazione Direttiva 97/23.
I valori di pressione indicati si riferiscono a piastre AISI 316L.

S125+

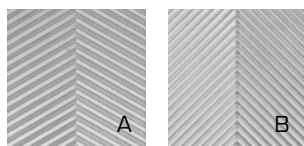

Piastre disponibili in due lunghezze termiche (A/B)

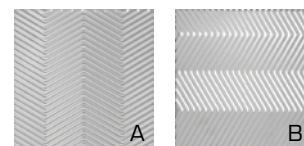

S180+

DN32

DN50

DN65

DN100

DN150

DN200

Dimensioni telai

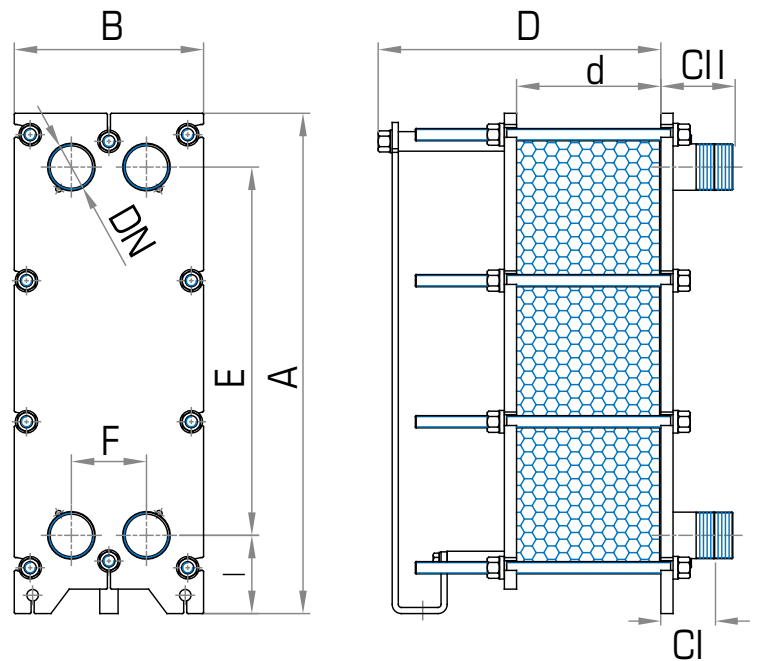

		S125+				S180+			
A		-				J - J	A-A B-B C-C E-E U-U V-V		
		819				996	1030		
B		310				392			
E		603				720			
F		123				192			
I		128				171,5			
Np max		41	71	101	151	41	71	101	151
D max		323	463	603	833	313	443	573	789
d (J-J)		3,3 x Np+2				2,85 x Np+2			
DN		DN65 2"1/2				DN65 2"1/2			
J-J	CI	88				88			
	CII	118				88			
M-M	CI-CII	93				93			
J-M	CI	84				84			
	CII	93				93			
Y-Y	CI	88				88			
	CII	118				88			
X-X K-K	CI	276				-			
	CII	236				-			
A-A B-B C-C E-E	CI	-				4			
U-U V-V	CI	-				0			

Tutte le dimensioni sono in mm - Np = numero di piastre

Disegni degli attacchi

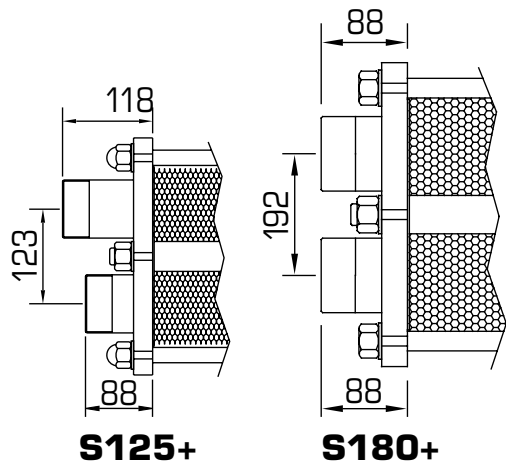

J-J

Attacchi mobili filettati maschio in AISI 316.

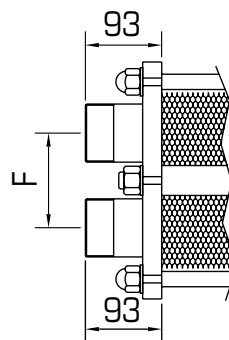

M-M

Attacchi mobili filettati maschio in PP.

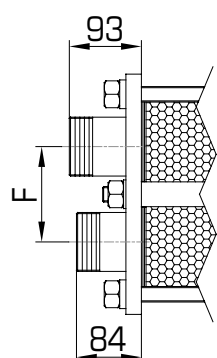

J-M

Attacchi mobili filettati maschio in AISI 316 e PP.

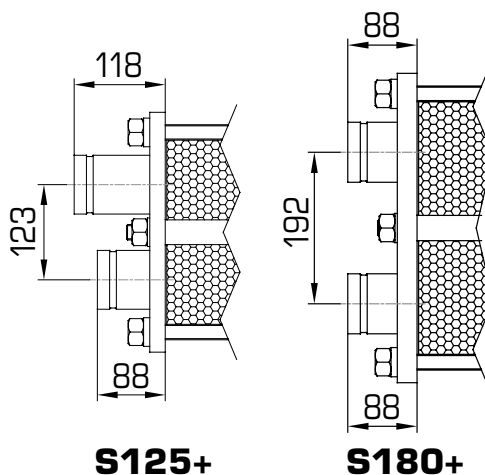

Y-Y

Attacchi mobili a estremità scanalata in AISI 316.

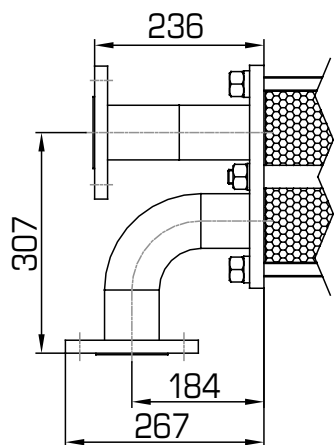

X-X

Flange mobili in acciaio inox AISI 304 (EN 1092-1). Tubo in AISI 316.

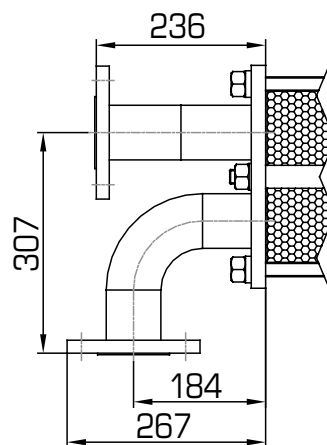

K-K

Flange mobili in acciaio al carbonio verniciato (EN-1092-1). Tubo in AISI 316.

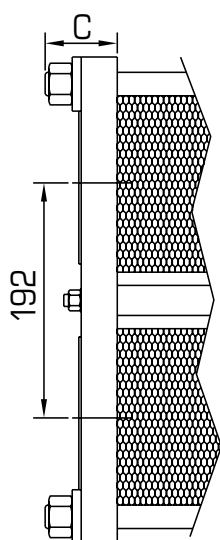

- A-A** A flangiare EN 1092-1 con manichette in gomma.
- B-B** A flangiare EN 1092-1 con manichette AISI 316.
- C-C** A flangiare EN 1092-1 senza manichette.
- E-E** A flangiare ANSI (fil. metrica) con manichette in gomma.
- U-U** A flangiare ANSI (fil. metrica) con manichette AISI316.
- V-V** A flangiare ANSI (fil. metrica) senza manichette.

Piedini

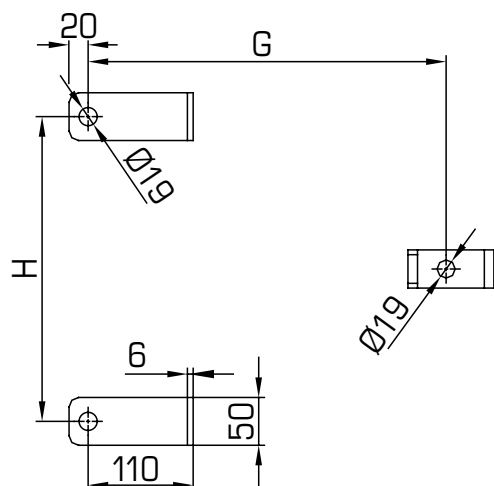

GxH	PS10	PS16
S125+		
Max 41p	380	385
Max 71p	520	540
Max 101p	660	665
Max 151p	890	895
S180+		
Max 41p	375	-
Max 71p	505	-
Max 101p	635	-
Max 151p	845	-

Materiali

		S125+	S180+
Piastre	AISI 304	●	●
	AISI 316L	●	●
	254 SMO	●	
	Titanio	●	●
Guarnizioni	NBR	●	●
	EPDM Prx.	●	●
	FPM	●	
	HNBR	●	
Telai	Acciaio Carbonio	●	●
	SS 304, pieno	●	●
Attacchi	J-J	●	●
	M-M	●	●
	J-M	●	●
	Y-Y	●	●
	X-X	●	
	K-K	●	
	A-A B-B C-C E-E U-U V-V		●

Materiali guarnizioni e temperature massime

NBR	-20 °C	110 °C
EPDM Prx.	-20 °C	160 °C
FPM	-20 °C	200 °C
HNBR	-20 °C	160 °C

Le temperature devono essere considerate non applicabili in tutte le condizioni di lavoro.

Esplso componenti Modelli S125+, S180+

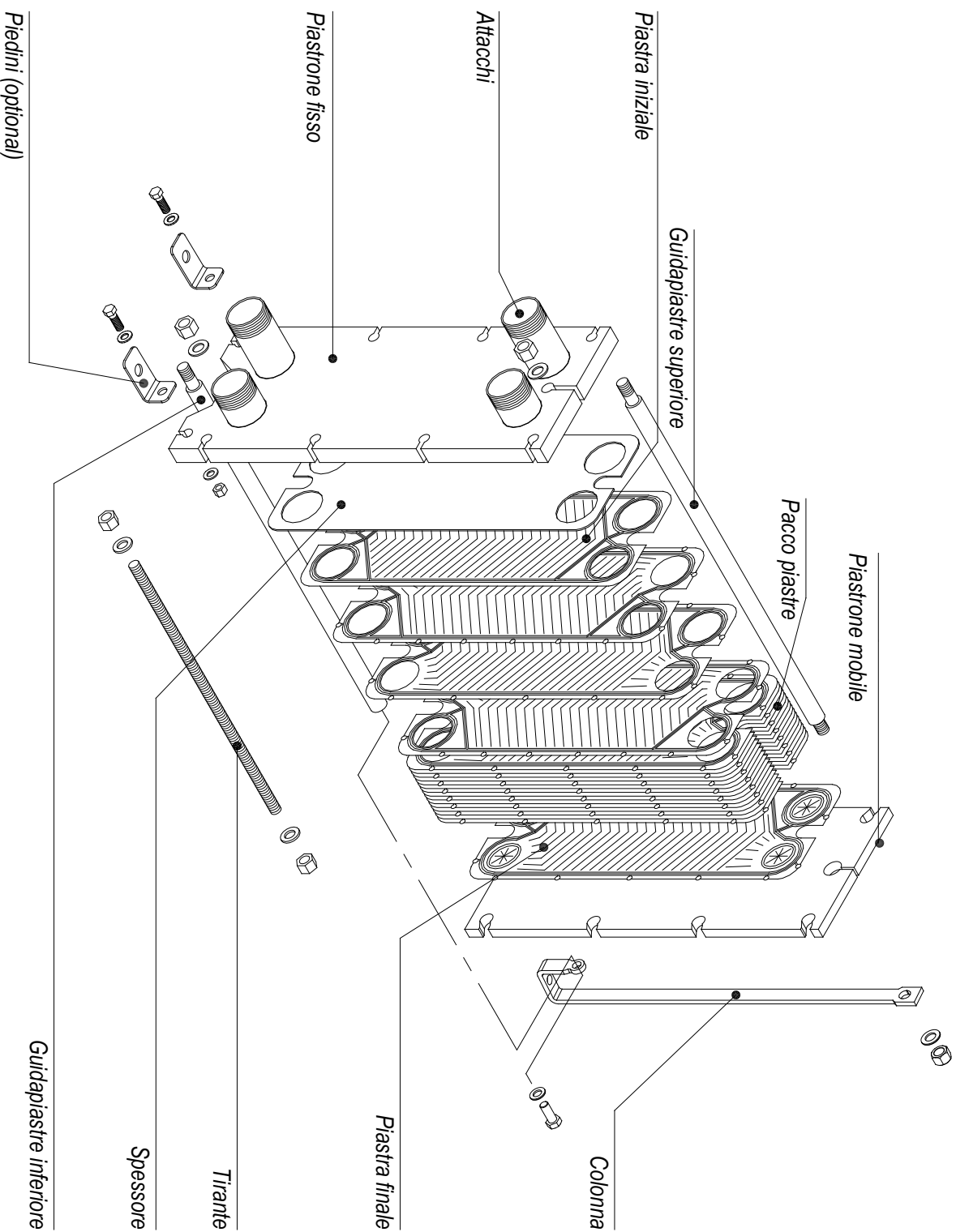

CERTIFICATIONS APPROVALS



- ISO EN 9001:2015 European Quality Certificates
- PED 2014/68/UE Pressure Equipment Directive Module B, D1 & D (up to Risk Cat. IV)



- ACS Attestation de Conformité Sanitaire



- WRAS EPDM/px gasket compound approved



- OHSAS 18001 Occupational Health and Safety



- ISO 14001 Environmental Management

MADE IN ITALY

